

Lampiran 1

KUESIONER
ANALISIS PEMANFAATAN KAWASAN BERIKAT

DATA RESPONDEN

Nama :

Jabatan :

Jenis Usaha : 1. Manufaktur 2. Perdagangan

Lokasi Perusahaan :

Mohon beri penilaian kondisi saat ini pada setiap uraian variabel dengan memberikan tanda silang (x) sesuai penilaian Saudara pada kolom 4!

Rendah-----tinggi

1	2	3	4	5	6	7
---	---	---	---	---	---	---

No	Uraian Variabel	Nilai Kondisi saat ini						
		1	2	3	4	5	6	7
1	2							
Fasilitas Internal								
Aksesibilitas internal								
1	Lebar jalan dalam kawasan							
2	Kondisi jalan dalam kawasan							
Utilitas								
3	Pasokan listrik							
4	Tarif listrik							
5	Pasokan air bersih							
6	Tarif air bersih							
7	Sambungan telepon							
8	Tarif telepon							
9	Saluran pembuangan limbah							
Pelayanan pendukung								
10	Bantuan keamanan							
11	Bantuan kesehatan							
12	Bantuan pemadam kebakaran							
13	Bantuan internet							
Proses pelayanan administrasi								
14	Penerbitan SKA							
Bangunan								
15	Kondisi bangunan							
16	Ketersediaan ukuran bangunan yang dibutuhkan							
17	Sewa bangunan							

Aksesibilitas eksternal									
18	Kedekatan dengan jln Cakung Cilincing								
19	Lebar jalan menuju jln Cakung Cilincing								
20	Kondisi jalan menuju jln Cakung Cilincing								
21	Waktu tempuh dari kawasan menuju Pelabuhan.								
22	Kondisi jalan Cakung Cilincing								
23	Kelancaran laulintas jalan Cakung Cilincing								
Sarana Promosi									
24	Pameran Produksi Indonesia								
Tenaga kerja									
25	Kemudahan memperoleh tenaga ahli								
26	Ketersediaan tenaga kerja buruh (unskill)								
27	Upah tenaga kerja								
Proses Ekspor Impor									
28	Proses impor								
29	Proses ekspor (pengkapalan)								
30	Proses administrasi (BC 23)								
Insentif pajak									
31	pajak bea masuk								
32	Cukai								
33	pajak pertambahan nilai								
34	Pajak penjualan BM								
35	PPh psl 22								
Persaingan									
36	Prospek usaha di KBN Marunda								
Pemanfaatan									
37	Pemanfaatan KBN Marunda secara umum								

Lampiran 2

Rekap Jawaban Responden

J U	x 1	x 1	x 2	x 2	x 2	x 3	x 3	x 3	x 3	x 3	x 3	x 4	x 4	x 4	x 4	x 5	x 6	x 6	x 6	x 6	x 6	x 7	x 8	x 8	x 8	x 9	x 9	x 9	x 10	x 11	Y																
1	5	5	5	6	5	7	3	5	5	5	6	6	5	6	3	5	3	2	1	3	2	6	7	5	6	5	7	6	2	6	6																
1	5	6	5	5	6	5	5	6	2	6	5	5	5	5	7	5	2	3	2	5	1	3	5	7	5	6	5	7	1	3	5																
1	5	6				5	7	5	3	5	6	5	7	5	6	3	1	5	2	2	1	3	6	5	5	7	5	6	1	5	5																
2	7	5				7	5	7	2	6	6	7	5	7	5	6	3	2	5	2	2	5	5	6	7	5	6	7	6	5	6																
1	7	5				5	5	6	3	6	5	5	5	5	6	6	2	3	1	3	3	3	5	6	5	7	5	5	6	5	5																
2	6	5				3	7	6	1	7	5	6	6	7	5	5	1	5	1	2	3	5	6	7	5	5	6	7	6	5	6																
2	7	6				5	5	6	3	6	5	5	5	6	7	7	1	2	5	3	2	3	6	6	5	7	5	6	6	7	6																
2	6	5				5	6	7	3	5	6	6	5	7	3	5	3	2	2	5	3	3	5	6	7	5	7	6	6	7	6																
1	7	6				3	7	5	2	5	6	7	3	5	7	5	3	5	1	2	5	3	5	6	7	5	5	6	2	5	5																
2	6	5				7	5	7	2	6	5	6	5	7	6	7	3	2	2	2	5	3	5	6	7	5	6	7	6	7	6																
2	5	6				5	6	7	2	7	6	6	5	5	7	5	2	3	2	2	3	6	7	5	6	7	5	6	3	7	6																
2	3	7				5	5	7	2	5	6	6	5	7	5	5	3	2	5	3	2	2	5	5	7	5	7	5	6	5	5																
2	7	6				3	5	6	3	5	6	6	6	5	5	7	1	3	2	5	3	3	7	6	5	7	5	6	6	5	6																
1	7	5	6	5	6	5	6	7	2	5	6	5	7	3	7	6	3	2	5	3	2	5	5	5	6	6	3	7	2	3	5																
2	6	5				5	7	6	2	7	5	7	5	5	6	5	3	1	2	3	2	2	5	6	5	5	7	5	6	7	5																
2	7	5				7	5	7	2	5	6	5	5	7	6	5	3	2	5	2	2	6	6	5	6	5	6	7	6	5	6																
2	5	5	7	6	5	5	5	6	3	7	5	6	5	7	5	5	1	3	2	5	3	6	7	6	5	6	5	7	6	7	6																
2	7	6	6	5	6	5	5	6	2	6	5	5	7	5	6	7	3	2	5	2	1	3	7	5	6	3	6	5	2	5	6																
1	5	7				5	6	7	3	5	6	5	6	5	7	5	1	2	2	5	3	2	6	3	6	5	7	6	2	7	6																
1	6	7	5	7	5	5	7	7	2	5	6	6	5	7	5	5	2	5	1	2	3	3	5	6	7	5	6	7	2	5	6																
1	5	7				6	7	5	1	7	3	6	5	7	5	5	1	3	2	5	2	3	5	6	7	7	6	3	2	7	6																
1	3	7	5	6	6	6	7	5	3	3	7	5	7	5	6		2	3	3	5	1										5	5															
1	6	7	5	7	6	5	3	6	2	5	7	5	7	5	6		5	2	3	3	2											6	6														
1	7	5	5	7	5	7	3	6	2	7	5	5	6	5	3		1	2	3	5	2											7	6														
1	5	6	5	6	5	6	7	5	1	7	5	5	7	5	3		1	5	3	2	2												5	5													
1	3	7	6	3	7	6	5	7	3	5	7	5	7	5	6		2	3	2	3	1													3	5												
1	5	6	5	7	5	6	5	6	3	7	5	5	7	3	7		1	2	3	2	2														5	5											
1	5	6	6	5	6	7	6	5	2	5	6	6	5	7	5		2	2	3	3	2															3	5										
1	6	5	3	5	6	5	5	7	2	6	7	6	5	7	7		1	3	2	5	2																7	6									
1	6	5	5	6	5	6	5	6	3	5	5	6	5	7	5		2	1	3	3	2																	5	6								
1	6	7	5	7	5	6	5	7	3	6	5	6	7	3	5		1	3	2	5	5																		5	5							
1	7	6	5	5	6	7	3	5	2	5	6	7	5	7	6		2	5	3	1	2																			7	6						
1	5	6	5	5	7	5	7	6	1	5	7	5	7	3	7		1	2	3	5	2																			5	5						
1	6	5	5	7	5	6	5	7	3	6	6	6	5	7	5		2	3	2	3	3																				7	6					
1	6	7	7	7	5	6	5	7	3	6	5	6	7	3	5		2	3	2	3	3																					5	6				
1	6	5	5	6	5	3	7	6	5	7	5	7	5	5	6		2	5	3	1	2																						5	5			
1	5	6	6	7	5	6	5	7	3	6	5	7	5	5	6		2	5	2	3	1																						5	6			
1	5	7	5	7	5	3	7	5	5	5	6	6	7	3	5		5	3	5	1	3																						5	5			
1	6	7	7	6	3	5	6	7	3	5	6	6	5	5	7		2	3	3	3	2																							5	5		
1	5	7	6	7	5	5	5	6	3	6	5	6	5	5	7		2	5	3	2	1																								6	6	
1	6	7	6	5	7	5	7	6	2	7	5	6	5	5	7		3	5	3	1	2																									5	6

```

SAVE OUTFILE='D:\DRAFT\tesis\tesis aris\fix 57.sav'
/COMPRESSED.
FREQUENCIES
  VARIABLES=x1.1 x1.3 x2.1 x2.2 x2.3 X3.1 X3.2 X3.3 X3.4 X3.5 X3.6 x4.1
  x4.2 x4.3 x4.4 x5 x6.1 x6.2 x6.3 x6.4 x6.5 x7.1 x8.1 x8.2 x8.3 x9.1
x9.2
  x9.3 x10.3 x11
/BARCHART PERCENT
/ORDER= ANALYSIS .

```

Frequencies

[DataSet1] D:\DRAFT\tesis\tesis aris\fix 57.sav

Frequency Table

x1.1 Lbr jl intern

		Frequency	Percent	Valid Percent	Cumulative Percent
Valid	3	4	5.1	5.1	5.1
	5	28	35.9	35.9	41.0
	6	21	26.9	26.9	67.9
	7	25	32.1	32.1	100.0
	Total	78	100.0	100.0	

x1.3 Kondisi jl. internal

		Frequency	Percent	Valid Percent	Cumulative Percent
Valid	3	4	5.1	5.1	5.1
	5	25	32.1	32.1	37.2
	6	27	34.6	34.6	71.8
	7	22	28.2	28.2	100.0
	Total	78	100.0	100.0	

x2.1 Kondisi bangunan

		Frequency	Percent	Valid Percent	Cumulative Percent
Valid	3	6	7.7	7.7	7.7
	5	37	47.4	47.4	55.1
	6	20	25.6	25.6	80.8
	7	15	19.2	19.2	100.0
	Total	78	100.0	100.0	

x2.2 Tipe bangunan

		Frequency	Percent	Valid Percent	Cumulative Percent
Valid	3	2	2.6	2.6	2.6
	5	33	42.3	42.3	44.9
	6	17	21.8	21.8	66.7
	7	26	33.3	33.3	100.0
	Total	78	100.0	100.0	

x2.3 Sewa bangunan

		Frequency	Percent	Valid Percent	Cumulative Percent
Valid	3	7	9.0	9.0	9.0
	5	40	51.3	51.3	60.3
	6	20	25.6	25.6	85.9
	7	11	14.1	14.1	100.0
	Total	78	100.0	100.0	

X3.1 Pasokan listrik

		Frequency	Percent	Valid Percent	Cumulative Percent
Valid	3	6	7.7	7.7	7.7
	5	30	38.5	38.5	46.2
	6	28	35.9	35.9	82.1
	7	14	17.9	17.9	100.0
	Total	78	100.0	100.0	

X3.2 Tarif listrik

		Frequency	Percent	Valid Percent	Cumulative Percent
Valid	3	4	5.1	5.1	5.1
	5	37	47.4	47.4	52.6
	6	15	19.2	19.2	71.8
	7	22	28.2	28.2	100.0
	Total	78	100.0	100.0	

X3.3 Pasokan air brs

		Frequency	Percent	Valid Percent	Cumulative Percent
Valid	3	4	5.1	5.1	5.1
	5	17	21.8	21.8	26.9
	6	23	29.5	29.5	56.4
	7	34	43.6	43.6	100.0
	Total	78	100.0	100.0	

X3.4 tarif air brs

		Frequency	Percent	Valid Percent	Cumulative Percent
Valid	1	12	15.4	15.4	15.4
	2	28	35.9	35.9	51.3
	3	33	42.3	42.3	93.6
	5	5	6.4	6.4	100.0
	Total	78	100.0	100.0	

X3.5 Sambungan telp

		Frequency	Percent	Valid Percent	Cumulative Percent
Valid	3	1	1.3	1.3	1.3
	5	37	47.4	47.4	48.7
	6	22	28.2	28.2	76.9
	7	18	23.1	23.1	100.0
	Total	78	100.0	100.0	

X3.6 Tarif telp.

		Frequency	Percent	Valid Percent	Cumulative Percent
Valid	3	3	3.8	3.8	3.8
	5	33	42.3	42.3	46.2
	6	23	29.5	29.5	75.6
	7	19	24.4	24.4	100.0
	Total	78	100.0	100.0	

x4.1 Keamanan

		Frequency	Percent	Valid Percent	Cumulative Percent
Valid	3	4	5.1	5.1	5.1
	5	23	29.5	29.5	34.6
	6	38	48.7	48.7	83.3
	7	13	16.7	16.7	100.0
	Total	78	100.0	100.0	

x4.2 kesehatan

		Frequency	Percent	Valid Percent	Cumulative Percent
Valid	3	9	11.5	11.5	11.5
	5	36	46.2	46.2	57.7
	6	5	6.4	6.4	64.1
	7	28	35.9	35.9	100.0
	Total	78	100.0	100.0	

x4.3 damkar

		Frequency	Percent	Valid Percent	Cumulative Percent
Valid	3	9	11.5	11.5	11.5
	5	38	48.7	48.7	60.3
	6	8	10.3	10.3	70.5
	7	23	29.5	29.5	100.0
	Total	78	100.0	100.0	

x4.4 internet

		Frequency	Percent	Valid Percent	Cumulative Percent
Valid	3	13	16.7	16.7	16.7
	5	29	37.2	37.2	53.8
	6	15	19.2	19.2	73.1
	7	21	26.9	26.9	100.0
	Total	78	100.0	100.0	

x5 SKA

		Frequency	Percent	Valid Percent	Cumulative Percent
Valid	3	1	1.3	4.8	4.8
	5	13	16.7	61.9	66.7
	6	3	3.8	14.3	81.0
	7	4	5.1	19.0	100.0
	Total	21	26.9	100.0	
Missing	System	57	73.1		
Total		78	100.0		

x6.1 Lebar Jalan Marunda

		Frequency	Percent	Valid Percent	Cumulative Percent
Valid	1	24	30.8	30.8	30.8
	2	26	33.3	33.3	64.1
	3	21	26.9	26.9	91.0
	5	7	9.0	9.0	100.0
	Total	78	100.0	100.0	

x6.2 Kondisi Jl. Marunda

		Frequency	Percent	Valid Percent	Cumulative Percent
Valid	1	3	3.8	3.8	3.8
	2	23	29.5	29.5	33.3
	3	31	39.7	39.7	73.1
	5	21	26.9	26.9	100.0
	Total	78	100.0	100.0	

x6.3 Kondisi Jalan CC

		Frequency	Percent	Valid Percent	Cumulative Percent
Valid	1	6	7.7	7.7	7.7
	2	22	28.2	28.2	35.9
	3	38	48.7	48.7	84.6
	5	12	15.4	15.4	100.0
	Total	78	100.0	100.0	

x6.4 WT ke Pel TP

		Frequency	Percent	Valid Percent	Cumulative Percent
Valid	1	13	16.7	16.7	16.7
	2	13	16.7	16.7	33.3
	3	37	47.4	47.4	80.8
	5	15	19.2	19.2	100.0
	Total	78	100.0	100.0	

x6.5 WT dari Pel. TP

		Frequency	Percent	Valid Percent	Cumulative Percent
Valid	1	10	12.8	12.8	12.8
	2	40	51.3	51.3	64.1
	3	18	23.1	23.1	87.2
	5	10	12.8	12.8	100.0
	Total	78	100.0	100.0	

Pameran Produksi Indonesia

		Frequency	Percent	Valid Percent	Cumulative Percent
Valid	2	3	3.8	14.3	14.3
	3	11	14.1	52.4	66.7
	5	3	3.8	14.3	81.0
	6	4	5.1	19.0	100.0
	Total	21	26.9	100.0	
Missing	System	57	73.1		
Total		78	100.0		

x8.1 Skill

		Frequency	Percent	Valid Percent	Cumulative Percent
Valid	5	11	14.1	52.4	52.4
	6	5	6.4	23.8	76.2
	7	5	6.4	23.8	100.0
	Total	21	26.9	100.0	
Missing	System	57	73.1		
Total		78	100.0		

x8.2 Unskill

		Frequency	Percent	Valid Percent	Cumulative Percent
Valid	3	1	1.3	4.8	4.8
	5	7	9.0	33.3	38.1
	6	11	14.1	52.4	90.5
	7	2	2.6	9.5	100.0
	Total	21	26.9	100.0	
Missing	System	57	73.1		
Total		78	100.0		

x8.3 Upah

		Frequency	Percent	Valid Percent	Cumulative Percent
Valid	5	8	10.3	38.1	38.1
	6	6	7.7	28.6	66.7
	7	7	9.0	33.3	100.0
	Total	21	26.9	100.0	
Missing	System	57	73.1		
Total		78	100.0		

x9.1 Proses impor

		Frequency	Percent	Valid Percent	Cumulative Percent
Valid	3	1	1.3	3.8	3.8
	5	11	14.1	42.3	46.2
	6	7	9.0	26.9	73.1
	7	7	9.0	26.9	100.0
	Total	26	33.3	100.0	
Missing	System	52	66.7		
Total		78	100.0		

x9.2 Proses ekspor

		Frequency	Percent	Valid Percent	Cumulative Percent
Valid	3	1	1.3	3.8	3.8
	5	9	11.5	34.6	38.5
	6	8	10.3	30.8	69.2
	7	8	10.3	30.8	100.0
	Total	26	33.3	100.0	
Missing	System	52	66.7		
Total		78	100.0		

x9.3 Proses adm. kepabeanan

		Frequency	Percent	Valid Percent	Cumulative Percent
Valid	3	3	3.8	11.5	11.5
	5	6	7.7	23.1	34.6
	6	8	10.3	30.8	65.4
	7	9	11.5	34.6	100.0
	Total	26	33.3	100.0	
Missing	System	52	66.7		
Total		78	100.0		

PPN

		Frequency	Percent	Valid Percent	Cumulative Percent
Valid	1	2	2.6	9.5	9.5
	2	7	9.0	33.3	42.9
	3	1	1.3	4.8	47.6
	6	11	14.1	52.4	100.0
	Total	21	26.9	100.0	
Missing	System	57	73.1		
Total		78	100.0		

Prospek

		Frequency	Percent	Valid Percent	Cumulative Percent
Valid	3	6	7.7	7.7	7.7
	5	41	52.6	52.6	60.3
	6	6	7.7	7.7	67.9
	7	25	32.1	32.1	100.0
Total		78	100.0	100.0	

Correlations

			Akses Intern	Bangunan	Utilitas	Pelayanan Pendukung	Pelayanan Adm.	Akses Eksteren	Pasar	TK	Proses Ekspor Impor	Kebijakan Insentif	Persaingan	Pemanfaatan
Spearman's rho	Akses Intern	Correlation Coefficient	1.000	.307(*)	.002	.149	.208	.199	-.182	-.020	-.228	-.127	.152	.432(**)
		Sig. (2-tailed)	.	.019	.989	.194	.365	.081	.429	.931	.264	.584	.183	.000
		N	78	58	78	78	21	78	21	21	26	21	78	78
	Bangunan	Correlation Coefficient	.307(*)	1.000	-.179	.214	.424	-.205	.424	.465	-.310	.775	.252	.555(**)
		Sig. (2-tailed)	.019	.	.179	.106	.402	.122	.402	.353	.550	.070	.056	.000
		N	58	58	58	58	6	58	6	6	6	6	58	58
	Utilitas	Correlation Coefficient	.002	-.179	1.000	.007	.130	-.079	.259	.156	.549(*)	.094	.035	.047
		Sig. (2-tailed)	.989	.179	.	.949	.576	.492	.257	.501	.004	.687	.760	.683
		N	78	58	78	78	21	78	21	21	26	21	78	78
	Pelayanan Pendukung	Correlation Coefficient	.149	.214	.007	1.000	-.011	-.169	-.205	-.062	.146	.238	.367(**)	.495(**)
		Sig. (2-tailed)	.194	.106	.949	.	.962	.139	.372	.790	.478	.299	.001	.000
		N	78	58	78	78	21	78	21	21	26	21	78	78
	Pelayanan Adm.	Correlation Coefficient	.208	.424	.130	-.011	1.000	.273	.159	.371	.116	.366	.218	.538(*)
		Sig. (2-tailed)	.365	.402	.576	.962	.	.231	.490	.098	.616	.103	.342	.012

	N	21	6	21	21	21	21	21	21	21	21	21	21
Akses Eksetern	Correlation Coefficient	.199	-.205	-.079	-.169	.273	1.000	.093	.328	-.031	.317	-.021	.046
	Sig. (2-tailed)	.081	.122	.492	.139	.231	.	.688	.146	.881	.162	.852	.688
	N	78	58	78	78	21	78	21	21	26	21	78	78
Pasar	Correlation Coefficient	-.182	.424	.259	-.205	.159	.093	1.000	.387	.289	.066	-.095	.381
	Sig. (2-tailed)	.429	.402	.257	.372	.490	.688	.	.083	.204	.778	.684	.088
	N	21	6	21	21	21	21	21	21	21	21	21	21
TK	Correlation Coefficient	-.020	.465	.156	-.062	.371	.328	.387	1.000	.212	.009	.151	.547(*)
	Sig. (2-tailed)	.931	.353	.501	.790	.098	.146	.083	.	.356	.970	.514	.010
	N	21	6	21	21	21	21	21	21	21	21	21	21
Proses Ekpor Impor	Correlation Coefficient	-.228	-.310	.549(*)	.146	.116	-.031	.289	.212	1.000	.192	.259	.485(*)
	Sig. (2-tailed)	.264	.550	.004	.478	.616	.881	.204	.356	.	.403	.202	.012
	N	26	6	26	26	21	26	21	21	26	21	26	26
Kebijakan Insentif	Correlation Coefficient	-.127	.775	.094	.238	.366	.317	.066	.009	.192	1.000	.313	.258
	Sig. (2-tailed)	.584	.070	.687	.299	.103	.162	.778	.970	.403	.	.168	.259
	N	21	6	21	21	21	21	21	21	21	21	21	21
Persaingan	Correlation Coefficient	.152	.252	.035	.367(**)	.218	-.021	-.095	.151	.259	.313	1.000	.608(**)

Pemanfaatan	nt												
	Sig. (2-tailed)	.183	.056	.760	.001	.342	.852	.684	.514	.202	.168	.	.000
	N	78	58	78	78	21	78	21	21	26	21	78	78
	Correlation Coefficient	.432(*)	.555(**)	.047	.495(**)	.538(*)	.046	.381	.547(*)	.485(*)	.258	.608(**)	1.000
	Sig. (2-tailed)	.000	.000	.683	.000	.012	.688	.088	.010	.012	.259	.000	.
	N	78	58	78	78	21	78	21	21	26	21	78	78

* Correlation is significant at the 0.05 level (2-tailed).

** Correlation is significant at the 0.01 level (2-tailed).

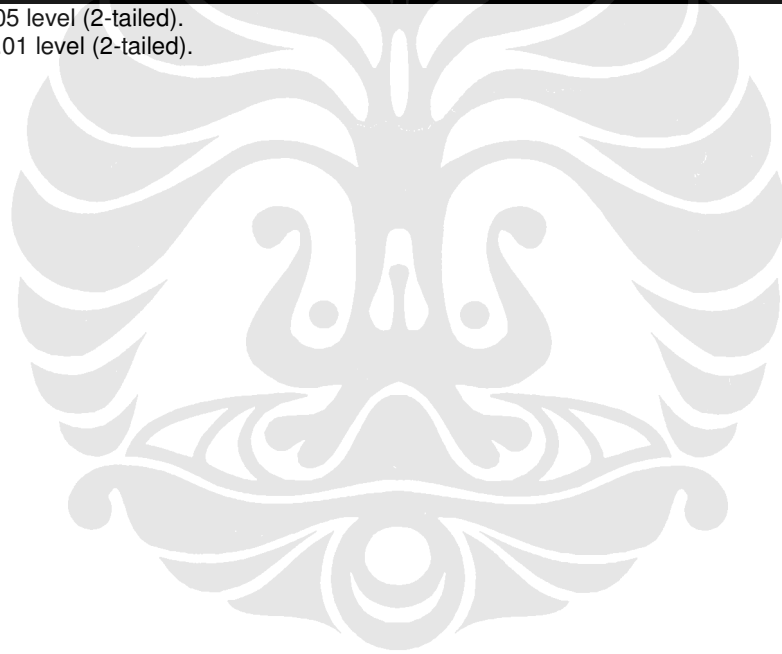

Means

Case Processing Summary

	Cases					
	Included		Excluded		Total	
	N	Percent	N	Percent	N	Percent
Akses Intern * Jenis Usaha	78	100.0%	0	.0%	78	100.0%
Bangunan * Jenis Usaha	58	74.4%	20	25.6%	78	100.0%
Utilitas * Jenis Usaha	78	100.0%	0	.0%	78	100.0%
Pelayanan Pendukung * Jenis Usaha	78	100.0%	0	.0%	78	100.0%
Pelayanan Adm. * Jenis Usaha	21	26.9%	57	73.1%	78	100.0%
Akses Eksetern * Jenis Usaha	78	100.0%	0	.0%	78	100.0%
Pasar * Jenis Usaha	21	26.9%	57	73.1%	78	100.0%
TK * Jenis Usaha	21	26.9%	57	73.1%	78	100.0%
Proses Ekpor Impor * Jenis Usaha	26	33.3%	52	66.7%	78	100.0%
Kebijakan Insentif * Jenis Usaha	21	26.9%	57	73.1%	78	100.0%
Persaingan * Jenis Usaha	78	100.0%	0	.0%	78	100.0%
Pemanfaatan * Jenis Usaha	78	100.0%	0	.0%	78	100.0%

Report

Mean

	Jenis Usaha		
	1	2	Total
Akses Intern	5.8231	5.7692	5.8141
Bangunan	5.7607	6.0000	5.7690
Utilitas	5.2185	5.1256	5.2030
Pelayanan Pendukung	5.5046	5.7115	5.5391
Pelayanan Adm.	4.8889	5.8333	5.4286
Akses Eksetern	2.7138	2.8000	2.7282
Pasar	3.4444	3.9167	3.7143
TK	5.6667	5.8611	5.7778
Proses Ekpor Impor	5.7667	5.8000	5.7833
Kebijakan Insentif	2.2222	5.4167	4.0476
Persaingan	5.4615	6.0769	5.5641
Pemanfaatan	5.5077	5.8462	5.5641

Lampiran 3

**PANDUAN WAWANCARA
ANALISIS PEMANFAATAN KAWASAN BERIKAT**

DATA RESPONDEN

Nama :

Lokasi Perusahaan :

No	Uraian pertanyaan	Jawaban
1	Hambatan apa yang Saudara temui dalam perjalanan pengiriman barang dari KBN Marunda ke pelabuhan Tanjung Priok	
2	Hambatan apa yang Saudara temui dalam perjalanan pengiriman barang dari KBN Marunda ke pelabuhan Tanjung Priok	
3	Apakah dengan mengikuti Pameran Produksi Indonesia dapat melakukan kontak dengan konsumen?	
4	Apakah dengan mengikuti Pameran Produksi Indonesia dapat memperkenalkan produk baru?	
5	Apakah dengan mengikuti Jakarta Pameran Produksi Indonesia meningkatkan konsumen?	
6	Apakah masih ada pungutan pajak di KBN Marunda?	
7	Bila masih ada apa saja yang masih dikenakan pungutan pajak?	
8	Apa yang membuat Saudara yakin bahwa berusaha di KBN Marunda memiliki prospek yang cerah?	

Lampiran 4

Panduan Observasi
ANALISIS PEMANFAATAN KAWASAN BERIKAT NUSANTARA MARUNDA

Lokasi : Blok C2 KBN Marunda
 Waktu :
 Sumber Data : Hasil observasi
 Yang diobservasi : Jalan Dalam Kawasan

Nama Jalan	Lapisan	Lebar (Meter)	Kondisi		Temuan
			Rusak	Baik	
Jl. Ujung Pandang					
Jl. Lampung					
Jl. Madiun					
Jl. Padang					

Lampiran 5

Panduan Observasi
ANALISIS PEMANFAATAN KAWASAN BERIKAT NUSANTARA MARUNDA

Lokasi : Blok C2 KBN Marunda
 Waktu :
 Sumber Data : Hasil observasi dan wawancara dengan pengelola kawasan
 Yang diobservasi : Bangunan Pabrik

Tipe Bangunan	Luas lantai	Kebersihan		Sirkulasi udara		Penerangan		Kerusakan			
		Kurang	bersih	pengap	Tidak pengap	Kurang terang	Cukup terang	Tembok		Atap	
								ada	tidak	ada	tidak
Tipe 1											
Tipe 2											
Tipe 3											

Sketsa

DENAH LANTAI 1 STANDART FACTORY BUILDING TIPE 3

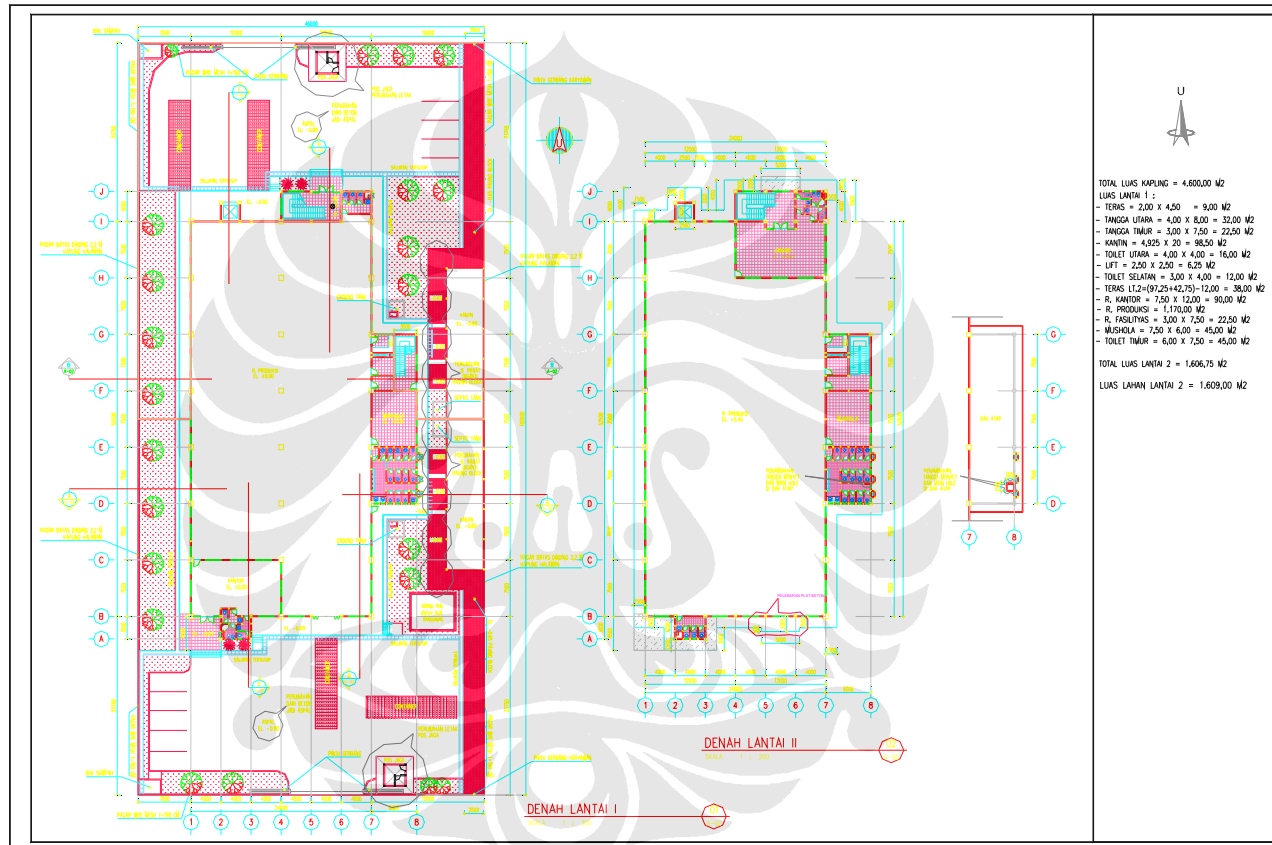

DENAH STANDART FACTORY BUILDING TIPE 6500

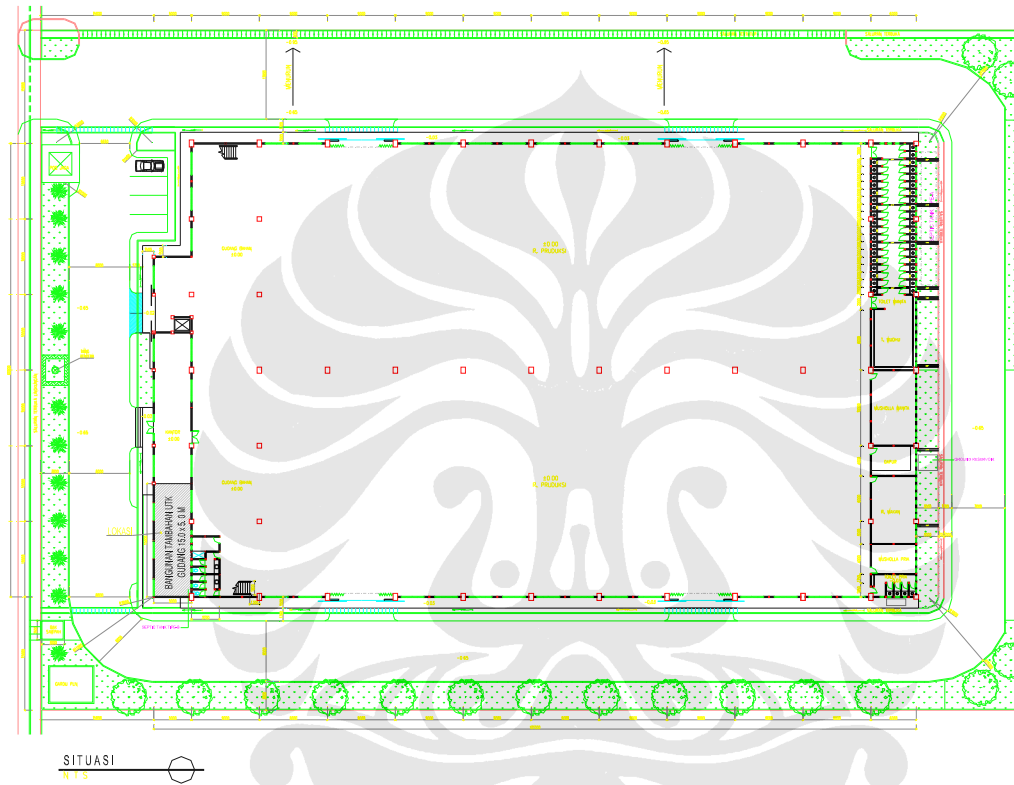

Lampiran 6

Panduan Observasi
ANALISIS PEMANFAATAN KAWASAN BERIKAT NUSANTARA MARUNDA

Lokasi : Blok C2 KBN Marunda
 Waktu :
 Sumber Data : Hasil observasi dan wawancara dengan pengelola kawasan
 Yang diobservasi : Bantuan Keamanan

Keamanan			Kesehatan			Pemadam Kebakaran		
Uraian	Tidak ada	Ada-jml	Uraian	Tdk ada	Ada/-jml/ Luas	Uraian	Tdk Ada	Ada
Pos Jaga			Ruang			Hydrant		
Personil			Dokter			Mobil PK		
Kendaraan			P3K					

Keterangan
Keamanan

.....

Kesehatan

.....

Pemadam Kebakaran

.....

Lampiran 7

Panduan Observasi
ANALISIS PEMANFAATAN KAWASAN BERIKAT NUSANTARA MARUNDA

Lokasi : Blok C2 KBN Marunda
 Waktu :
 Sumber Data : Hasil observasi
 Yang diobservasi : Jalur Lalulintas KBN Marunda

Nama Jalan	Lebar (Meter)	Kondisi		Keterangan
		Rusak	Baik	
Jl. Marunda Baru				
Jl.Cakung Cilincing				

Hambatan di route KBN Marunda - pelabuhan Tanjung Priok.....